

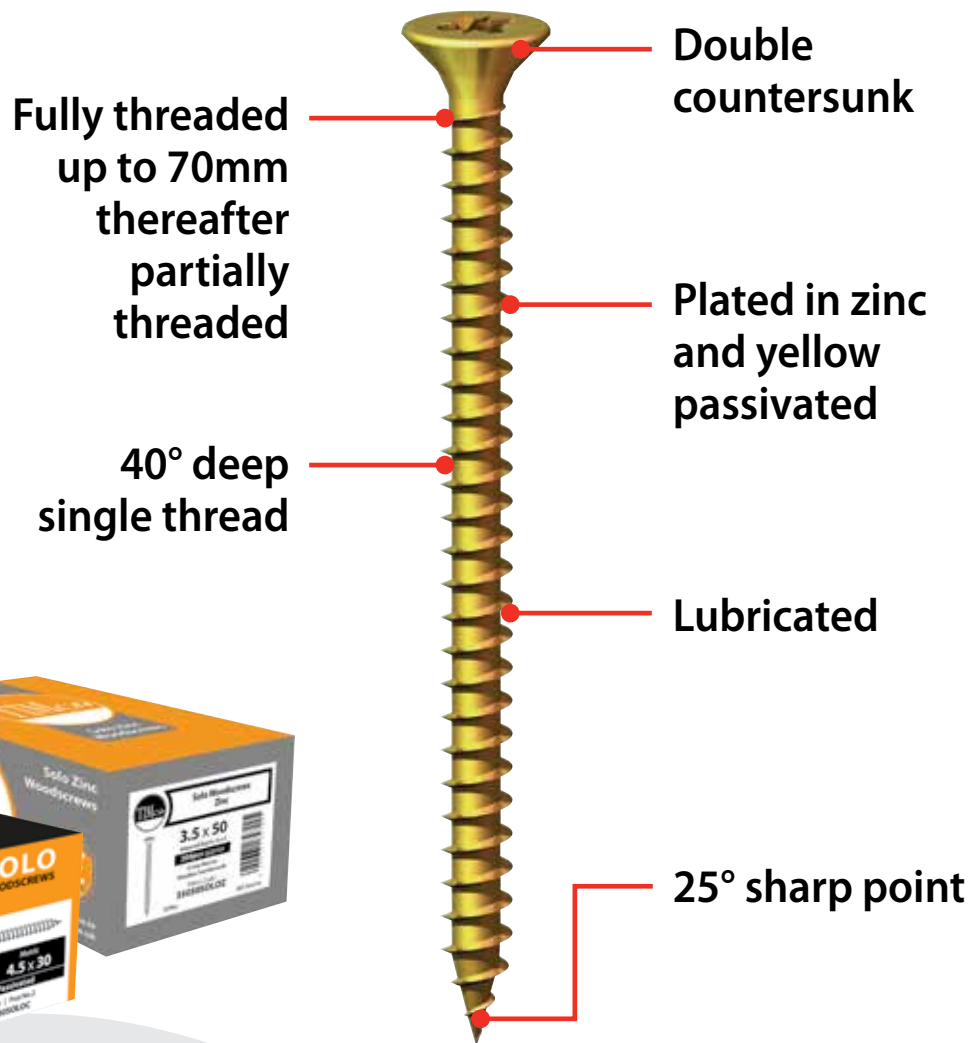

CE Declaration of Performance

Solo

Woodscrews



Certain Hardwood



Softwood



PVC u

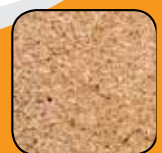

Chipboard

Dimensional & Performance Declaration

Solo Zinc Cross Recess and Square Recess Double Countersunk

Size	Nominal diameter d (mm)	Inner thread diameter d1	Total Length L (mm)	Thread Length lg (mm)	Head diameter dh (mm)	Test Report No.	Certificate No.	Characteristic yield moment $M_{y,k}$ (Nmm)	Characteristic withdrawal parameter $f_{ax,k}$ (N/mm ²)		Characteristic head pull-through parameter $f_{head,k}$ (N/mm ²)	Characteristic tensile capacity $f_{tens,k}$ (kN)	Characteristic torsional ratio
									Loading across the fibre	Loading along the fibre			
3.0 x 12 3.0 x 15 3.0 x 17 3.0 x 20 3.0 x 25 3.0 x 30	3.0	2.00	12	8.85	6	No. 30-9797/7	E-30-20008-13	1 051	17,99	12,37	45,41	3,11	6,28
15			11.85										
17			13.85										
20			16.85										
25			21.85										
30			26.85										
3.5 x 12 3.5 x 15 3.5 x 17 3.5 x 20 3.5 x 25 3.5 x 30 3.5 x 35 3.5 x 40 3.5 x 50	3.5	2.25	12	8.18	7	No. 30-9797/8	E-30-20009-13	2 873	18,55	11,04	35,55	4,57	2,90
15			11.18										
17			12.18										
20			16.18										
25			21.18										
30			26.18										
35			31.18										
40			36.18										
50			46.18										
4.0 x 15 4.0 x 17 4.0 x 20 4.0 x 25 4.0 x 30 4.0 x 35 4.0 x 40 4.0 x 45 4.0 x 50 4.0 x 55 4.0 x 60	4.0	2.50	15	10.83	8	No. 30-9797/9	E-30-20010-13	4 186	17,85	11,52	28,02	5,99	3,45
17			12.83										
20			15.83										
25			20.8										
30			25.8										
35			32.8										
40			35.8										
45			40.8										
50			45.8										
55			50.8										
60			55.8										
4.5 x 20 4.5 x 30 4.5 x 35 4.5 x 40 4.5 x 45 4.5 x 50 4.5 x 60 4.5 x 70 4.5 x 80			4.0	2.50									
30	25.26												
35	30.26												
40	35.26												
45	40.26												
50	45.26												
60	55.26												
70	65.26												
80	70												
5.0 x 25 5.0 x 30 5.0 x 35 5.0 x 40 5.0 x 45 5.0 x 50 5.0 x 60 5.0 x 70 5.0 x 75 5.0 x 80 5.0 x 90 5.0 x 100	5.0	3.10	25	19.6	10	No. 30-9797/11	E-30-20012-13	7 157	18,29	10,12	24,90	9,74	3,86
30			24.6										
35			29.6										
40			34.6										
45			39.6										
50			44.6										
60			54.6										
70			64.6										
75			70										
80			70										
90			70										
100			70										
6.0 x 40 6.0 x 50 6.0 x 60 6.0 x 70 6.0 x 80 6.0 x 90 6.0 x 100 6.0 x 120 6.0 x 130 6.0 x 150			6.0	3.80									
50	43.9												
60	53.9												
70	63.9												
80	70												
90	70												
100	70												
120	70												
130	70												
150	70												

Durability: Service Class 1 acc. To EN1995-1-1)

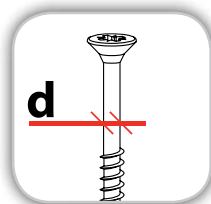

Nominal Diameter

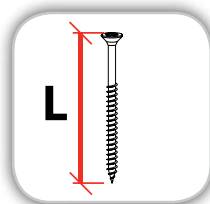

Total Length

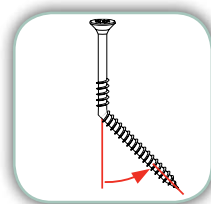

Yield Movement

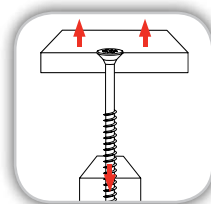

Withdrawal Parameter

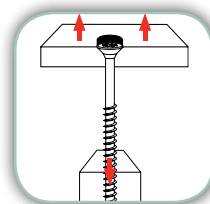

Head Pull-through

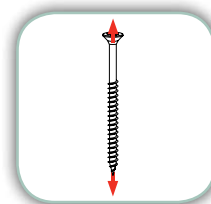

Torsional Ratio

Dimensional & Performance Declaration

Solo Zinc Cross Recess and Square Recess Double Countersunk

Size	Nominal diameter d (mm)	Inner thread diameter d1	Total Length L (mm)	Thread Length lg (mm)	Head diameter dh (mm)	Test Report No.	Certificate No.	Characteristic yield moment $M_{y,k}$ (Nmm)	Characteristic withdrawal parameter $f_{ax,k}$ (N/mm ²)		Characteristic head pull-through parameter $f_{head,k}$ (N/mm ²)	Characteristic tensile capacity $f_{tens,k}$ (kN)	Characteristic torsional ratio
									Loading across the fibre	Loading along the fibre	Csk		
3.0 x 12 3.0 x 15	3.0	2.00	12	8.85	6	No. 30-9797/7	E-30-20008-13	1 051	17,99	12,37	45,41	3,11	6,28
15			11.85										
3.5 x 15 3.5 x 20 3.5 x 25 3.5 x 30 3.5 x 35 3.5 x 40 3.5 x 50	3.5	2.25	15	11.18	7	No. 30-9797/8	E-30-20009-13	2 873	18,55	11,04	35,55	4,57	2,90
20			16.18										
25			21.18										
30			26.18										
35			31.18										
40			36.18										
50			46.18										
4.0 x 15 4.0 x 17 4.0 x 20 4.0 x 25 4.0 x 30 4.0 x 35 4.0 x 40 4.0 x 45 4.0 x 50 4.0 x 60 4.0 x 70	4.0	2.50	15	10.83	8	No. 30-9797/9	E-30-20010-13	4 186	17,85	11,52	28,02	5,99	3,45
17			12.83										
20			15.83										
25			20.83										
30			25.83										
35			30.83										
40			35.83										
45			40.83										
50			45.83										
60			55.83										
70			65.83										
4.5 x 40 4.5 x 45 4.5 x 50 4.5 x 60 4.5 x 70			4.5	2.70									
45	40.26												
50	45.26												
60	55.26												
70	65.26												
5.0 x 25 5.0 x 30 5.0 x 40 5.0 x 45 5.0 x 50 5.0 x 60 5.0 x 70 5.0 x 80 5.0 x 90 5.0 x 100	5.0	3.10	25	19.6	10	No. 30-9797/11	E-30-20012-13	7 157	18,29	10,12	24,90	9,74	3,86
30			24.6										
40			34.6										
45			39.6										
50			44.6										
60			54.6										
70			64.6										
80			70										
90			70										
100			70										
6.0 x 50 6.0 x 60 6.0 x 80 6.0 x 90 6.0 x 100 6.0 x 120 6.0 x 150	6.0	3.80	50	43.9	12	No. 30-9797/12	E-30-20013-13	11 810	16,94	10,18	27,70	11,88	2,94
60			53.9										
80			70										
90			70										
100			70										
120			70										
150			70										

Durability: Service Class 1 acc. To EN1995-1-1)

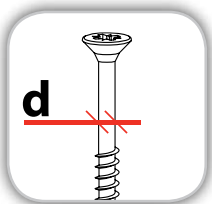

Nominal Diameter

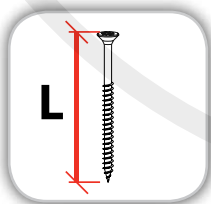

Total Length

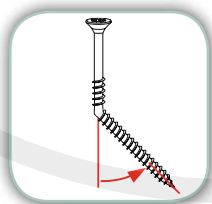

Yield Movement

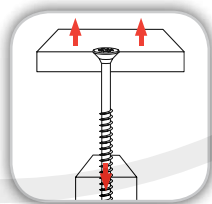

Withdrawal Parameter

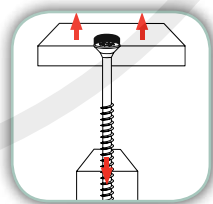

Head Pull-through

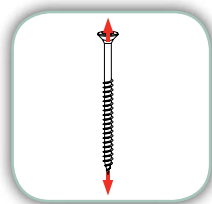

Torsional Ratio

TIMco SOLO Woodscrews



DECLARATION OF PERFORMANCE

DOP2 v4

We here by declare the following designated products

TIMco SOLO Woodscrews
Diameter 3.0mm, 3.5mm, 4.0mm, 4.5mm, 5.0mm, 6.0mm.

Have been tested by the following independent testing organisation:

- Notified Body 1015
Strojirensky Zkusebni Ustav, s.p., Czech Republic

And that they have performed initial type testing under system 3, Annex V of the regulation (EU) no. 305/2011 (Construction Products Regulation), with the reference to the harmonised European standard (hEN) BS EN 14592:2008+A1:2012 (Timber structures - Dowel type fasteners - Requirements) for nails intended for the use in "load bearing timber structures" and produced the calculation/test reports as listed below;

Certificate Number: E-30-20007-13 to E-30-20013-13

Test Report Number: No. 30-9797/1 to No. 30-9797/12.

Factory Process Control (FPC) has been established by the factory and independently audited by TUV Rheinland UK in accordance with ISO9001:2008..

This declaration of conformity is valid until there is a significant change in the product and declared characteristics. ie. raw material or change in production process.

Signed by:

Name: *Simon Midwood*

Position: *Managing Director*

Date & Location: *17. 07. 2015*
TIMco House, CW5 6BJ

This declaration is the responsibility of the importer

T.I Midwood & Co. Ltd. Green Lane, Wardle, Nantwich, Cheshire, CW5 6BJ

